

UPUTE ZA MONTAŽU

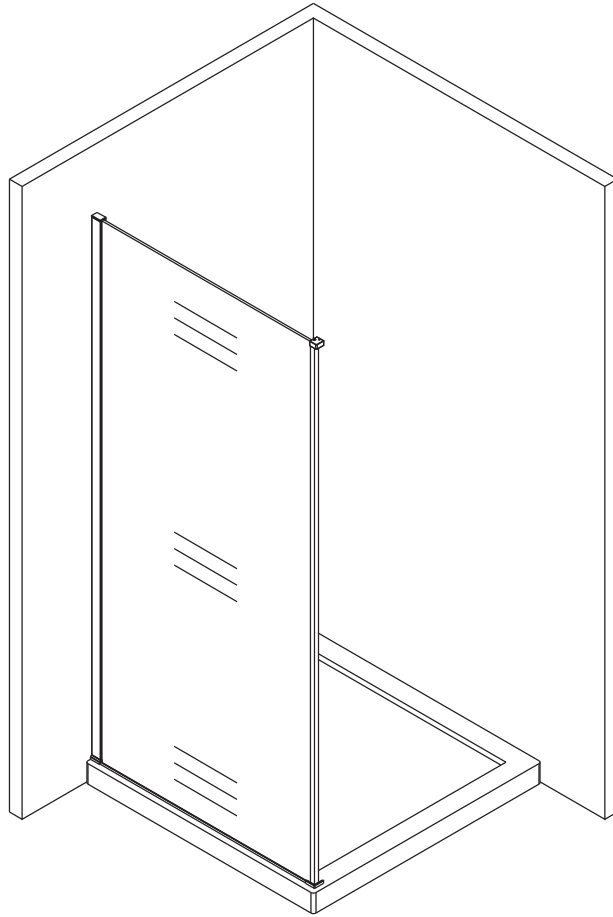

Napomena:

Provjerite da li su svi dijelovi upakirani. Pažljivo zaštitite područje oko tuša. Kaljeno staklo (ESG) je prema svojoj strukturi plošno otporno na udarce, ali je jako osjetljivo na rubovima (čoškovima). Treba biti iznimno oprezan prilikom manipulacije, a pogotovo prilikom okomitog odlaganja (predlažemo da staklo ne spuštate na pločice ili beton već samo na meku podlogu kao stiropor ili deblji karton) jer će u tom slučaju cijela težina stakla biti na rubu i lako može doći do prsnuća stakla. Zaštitu rubova ne skidajte do samog kraja montaže. Kaljeno staklo (ESG) ne smije se rezati, polirati ili bušiti jer će se odmah rasprsnuti. Kod montaže nosite rukavice i sigurnosne naočale. Staklo je teško, a dlanovi su uvijek masni i/ili znojni te iz tog razloga staklo lako sklizne iz ruku i rub stakla padne na pod te dolazi do prsnuća. Iz tog razloga za montažu su potrebne dvije osobe s tim da barem jedna mora imati iskustva u montaži.

POTREBAN ALAT

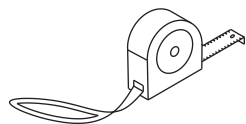

METAR

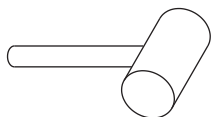

GUMENI ČEKIČ

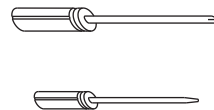

RAVNI I KRIŽNI ODVIJAČ



LIBELA



PIŠTOLJ ZA SILIKON



OLOVKA



IMBUS KLJUČ

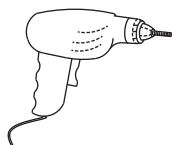

EL. BUŠILICA

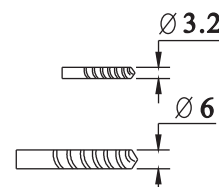

($\varnothing 6$ $\varnothing 3.2$)

SVRDLA ZA
BUŠILICU

LISTA PAKIRANJA

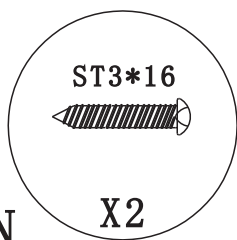
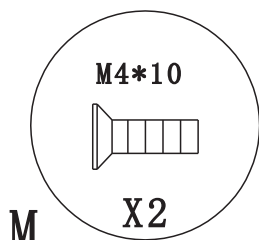
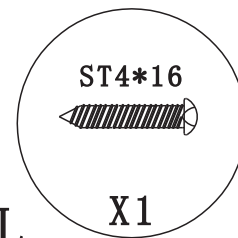
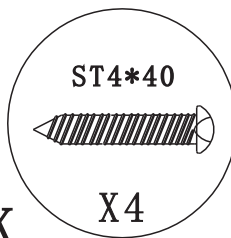
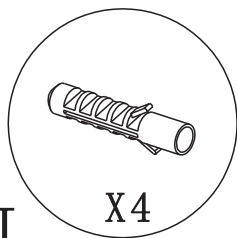
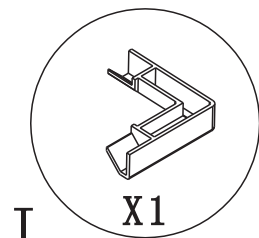
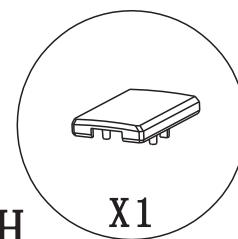
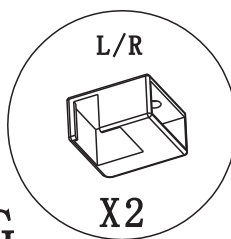
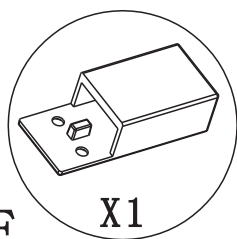
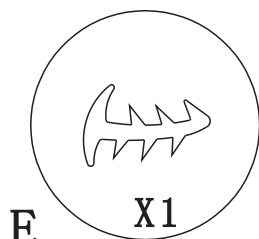
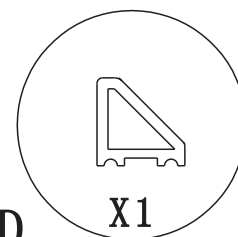
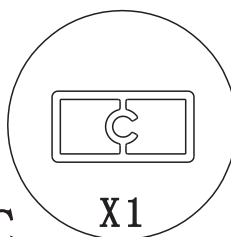
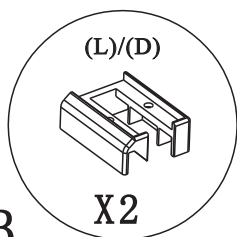
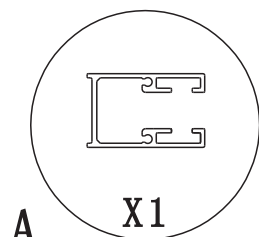

TEHNIČKI NACRT

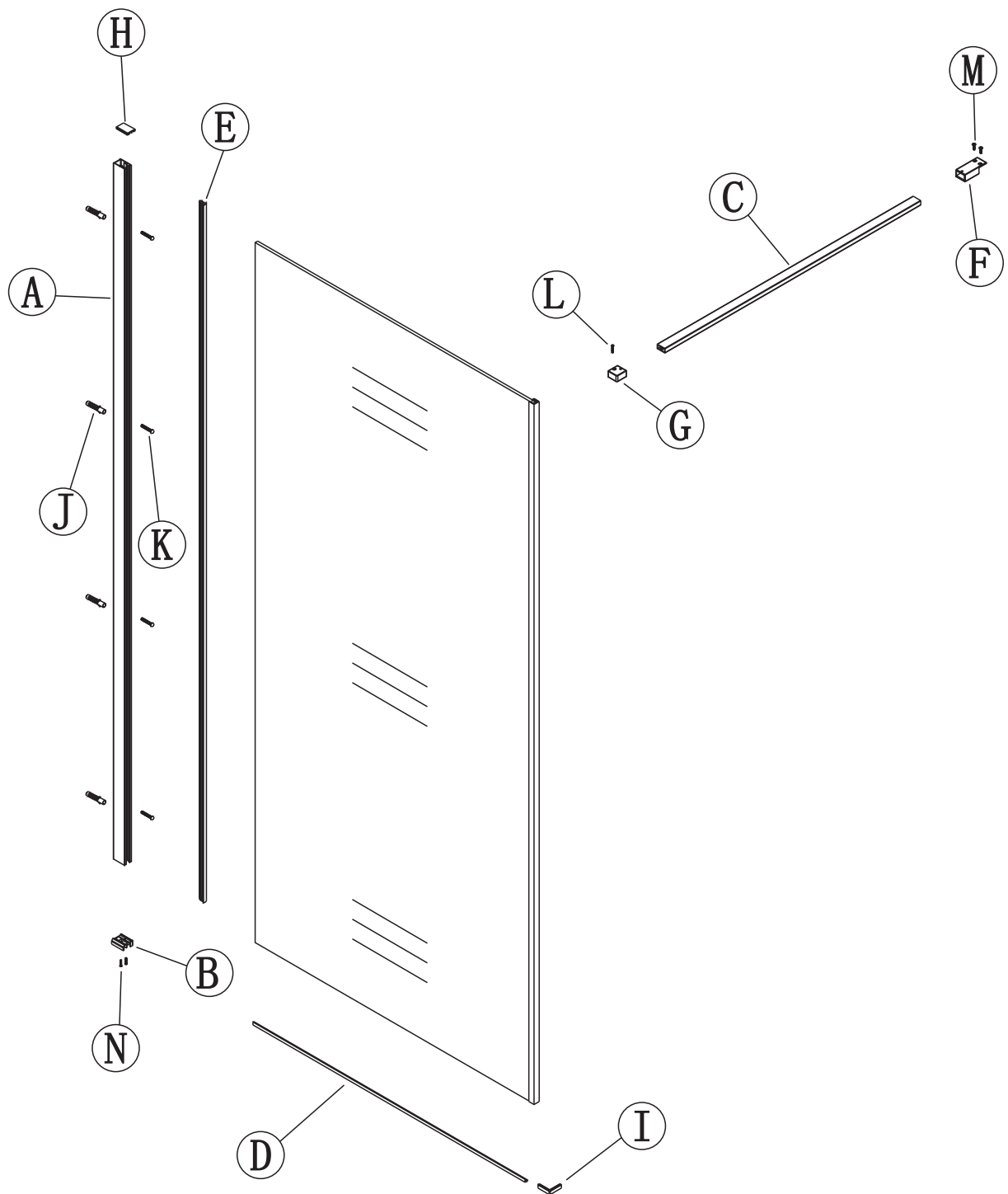

1

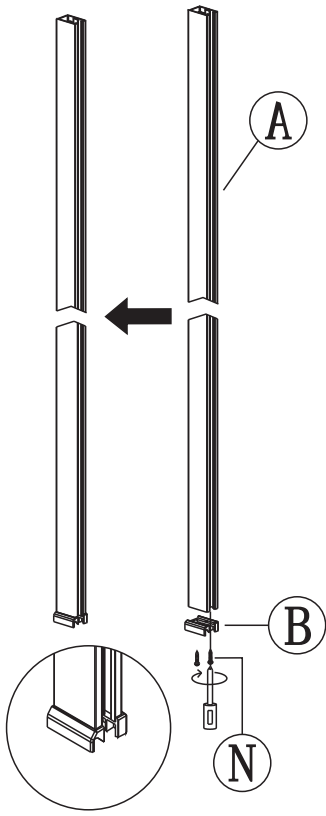

2

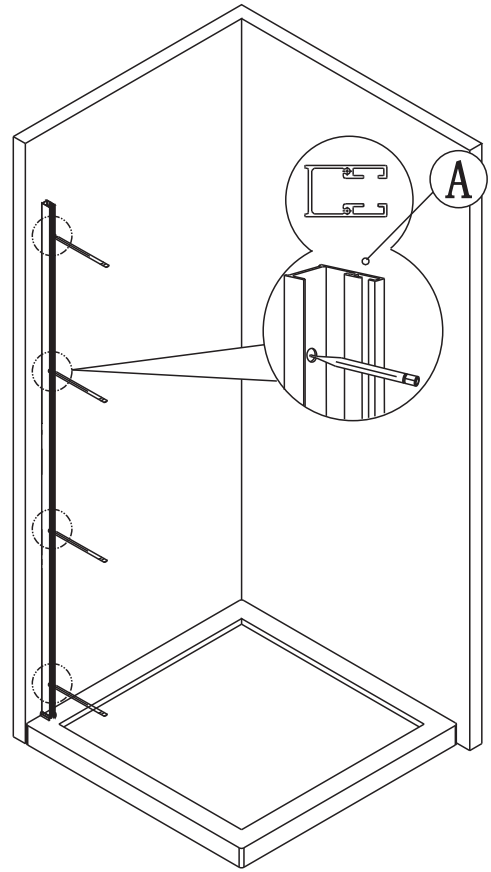

3

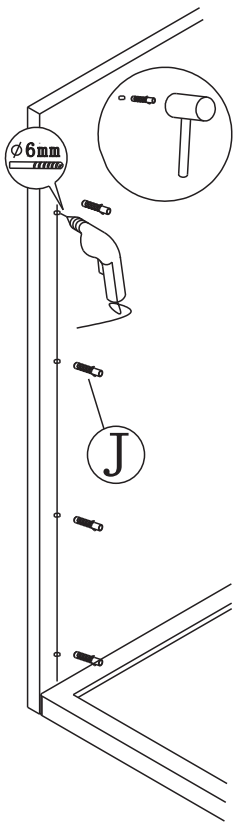

4

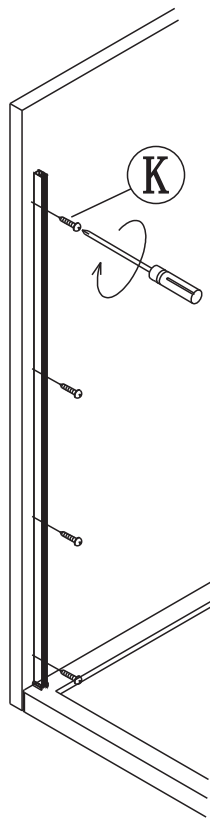

5

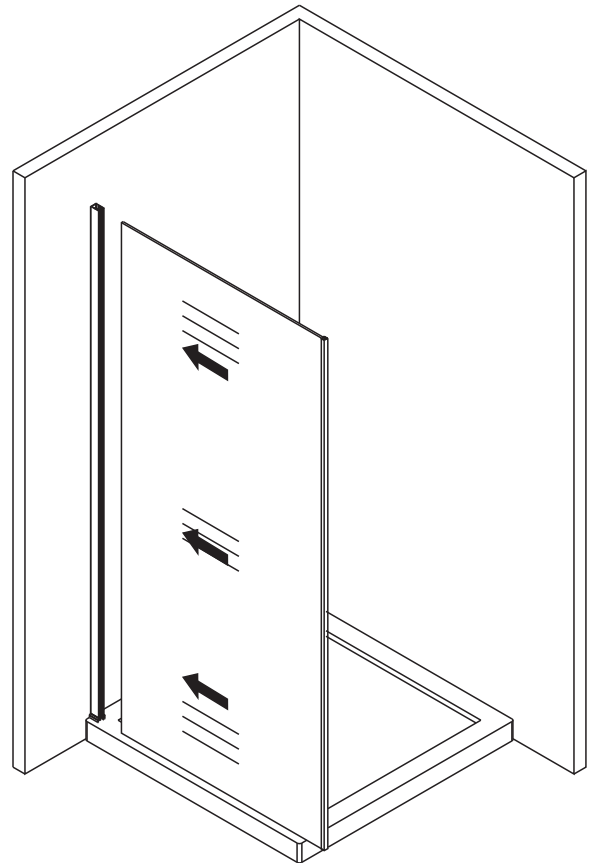

(3)

6

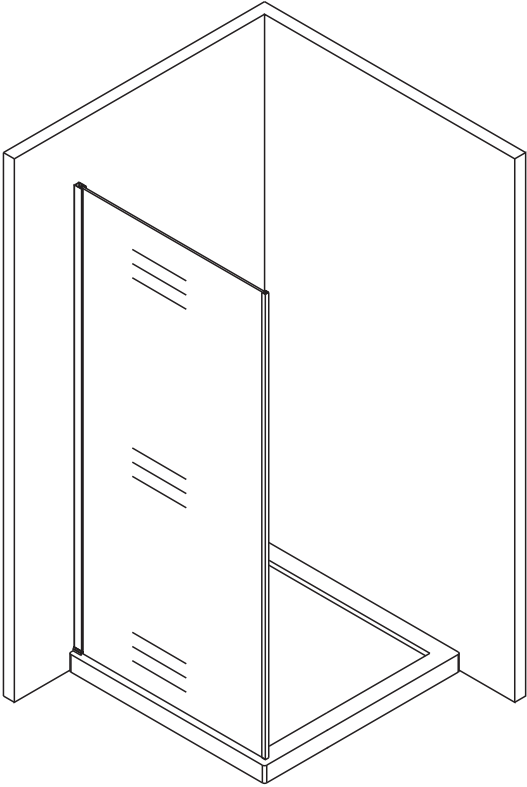

7

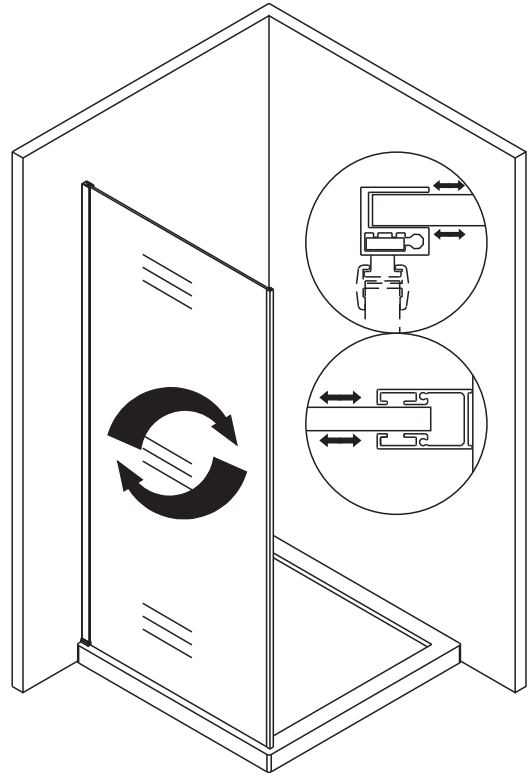

8

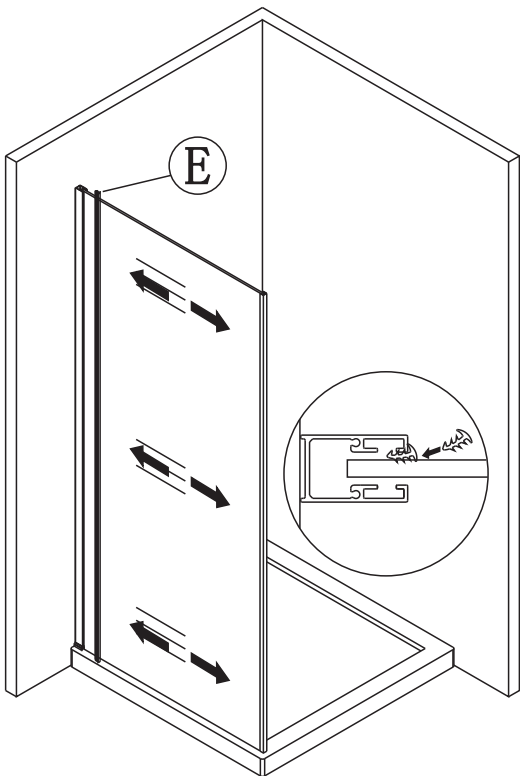

9

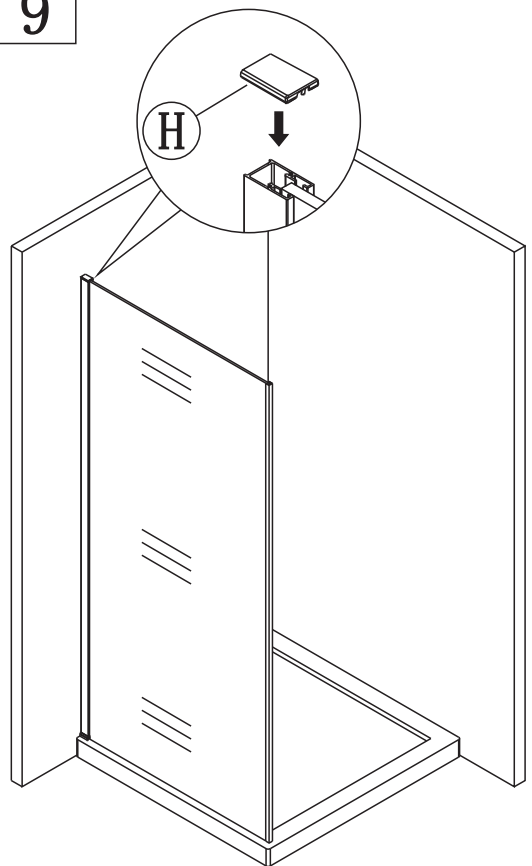

Opcija 1: Mogućnost montaže sa vratima PN1

a

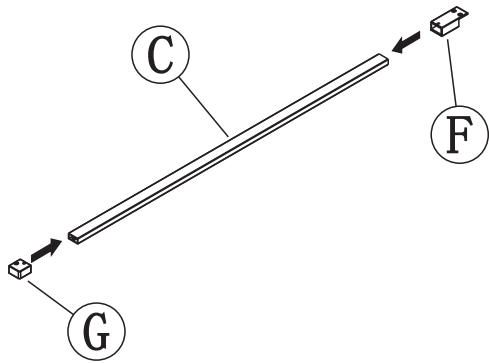

b

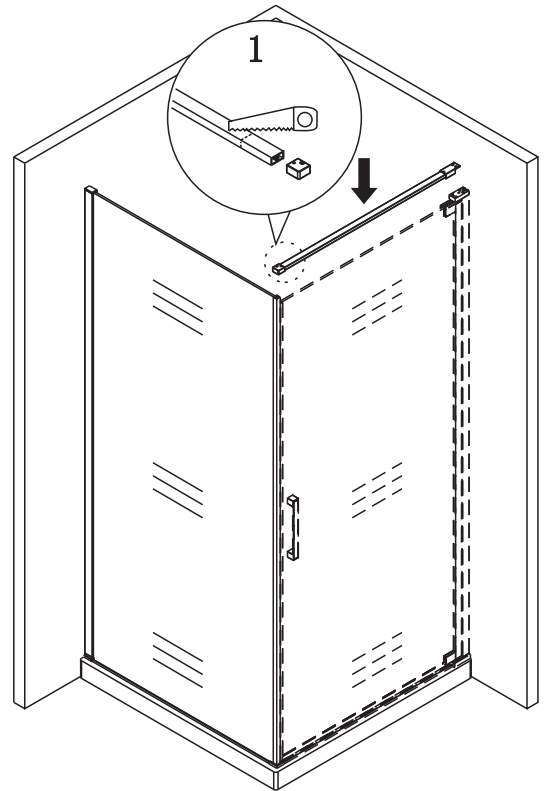

c

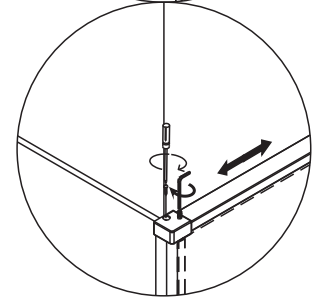
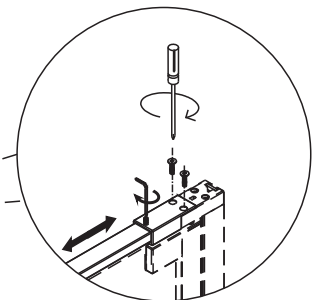
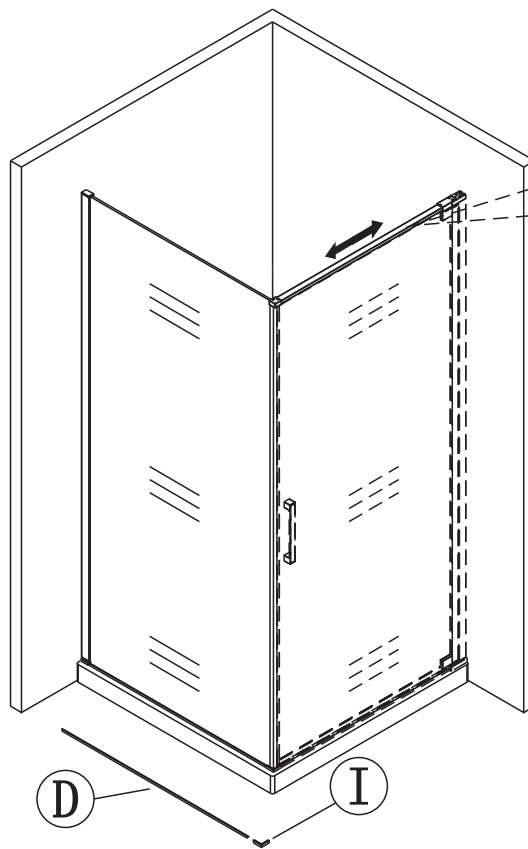
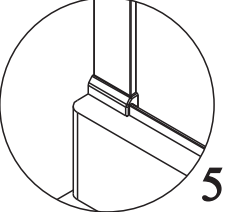
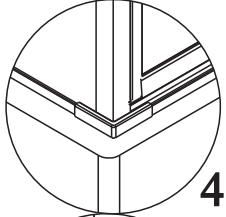
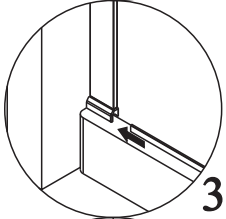
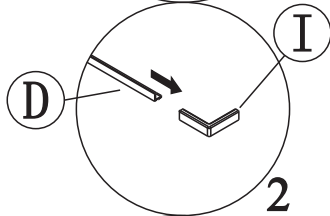
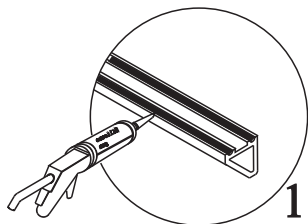

(5)

d

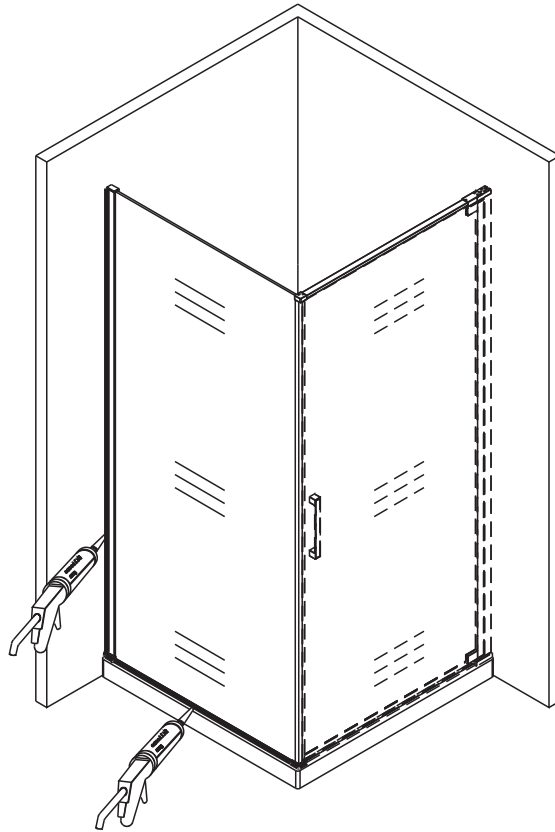

Opcija 2: Mogućnost montaže s vratima PN 3

a

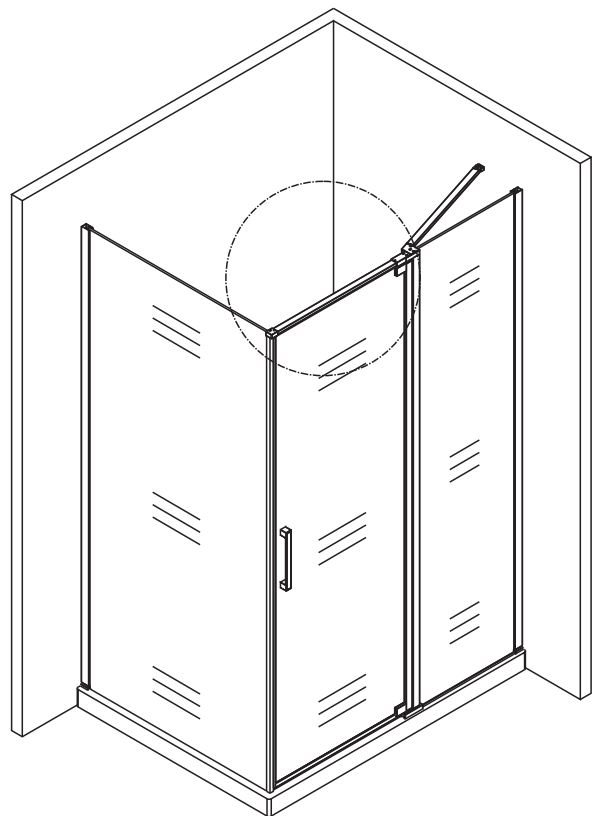
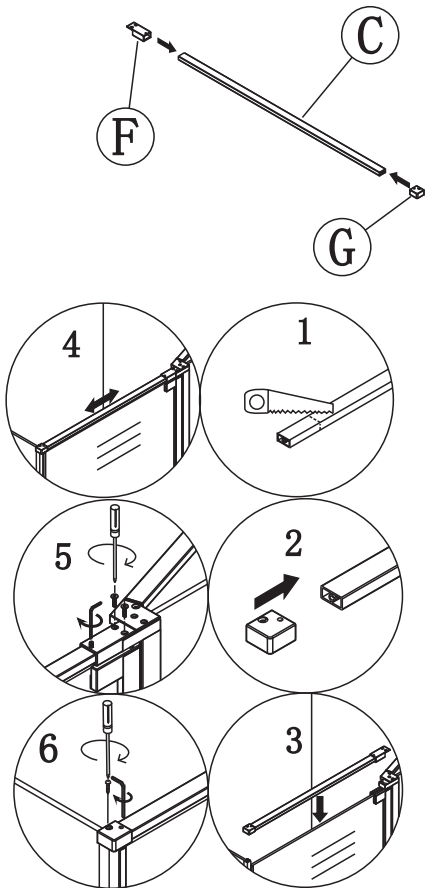

(6)

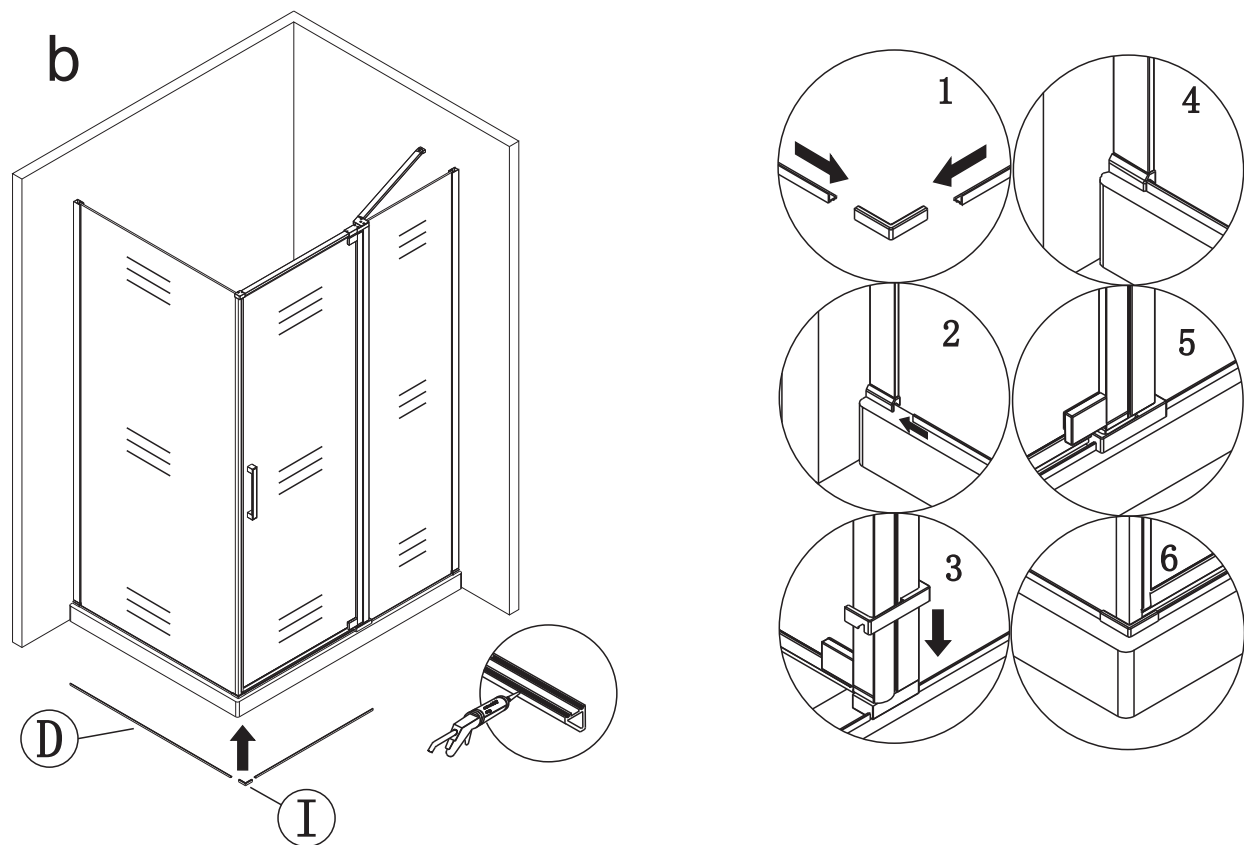

NAPOMENA: Kabinu silikonirajte samo sa vanjske strane

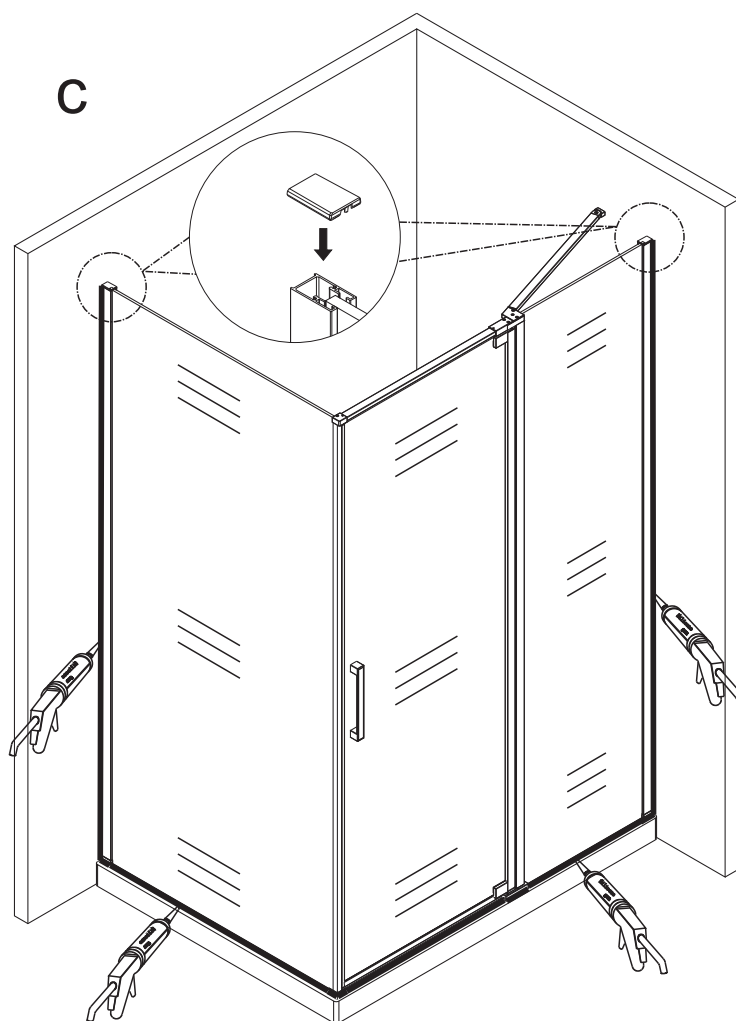

(7)

ČIŠĆENJE I ODRŽAVANJE

Održavajte i čistite svoju kabinu redovito kako bi spriječili nastanak kamenca i problema prilikom zatvaranja.

Čišćenje tuš kabine vršite s mekom krpom i blagim deterdžentom.

Kabinu ne čistite s agresivnim sredstvima kao što su alkohol, benzin ili ostala kućna sredstva.

Nakon što je kabina postavljena ukoliko prilikom otvaranja/zatvaranja vrata škripe možete sredstvo za podmazivanje staviti na valjak kotača, profil.